

## In-Line Lubricators

Designed to protect portable or stationary air tools by efficiently oiling the tool mechanisms. Each time an air tool is operated, a fine mist of oil is injected into it along with the air from the compressor. Installation is recommended within 25 feet of the tool to be lubricated. Refer to the arrow for proper air flow direction. Transparent sight disc allows visual inspection of oil level. Oil flow regulated by screwdriver screw adjustment. Not recommended for constant flow applications. For reciprocating tools only. Minimum flow rate is 30 SCFM.

Type of oil to use:

Use any petroleum-base, non-detergent light weight oil (SAE 10/150SSU) which will readily break up into a mist, i.e., Mobil DTE light or comparable oil. *Do not use any synthetic oil or oils containing additives or solvents.*

**SAFETY**  
**ALERT**

See page 124 for air tool lubricant.

☰  
Air



NPT Sizes	Oil Capacity	Maximum Working Pressure	Air Flow at 70 PSI	Part #	Price/E
1/2"	1.4 fluid ozs.	<b>500 PSI</b>	30 SCFM	<b>PL300</b>	<b>\$105.50</b>
3/4"	3.7 fluid ozs.	<b>200 PSI</b>	70 SCFM	<b>PL400</b>	<b>110.80</b>
3/4"	11.0 fluid ozs.	<b>300 PSI</b>	70 SCFM	<b>PL400L</b>	<b>137.40</b>
1"	16.0 fluid ozs.	<b>250 PSI</b>	100 SCFM	<b>PL500</b>	<b>183.20</b>

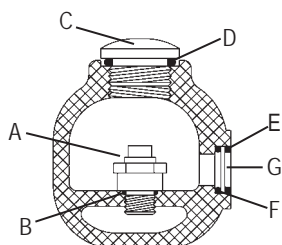

### Replacement Parts

Description	Part #	Price/E	Description	Part #	Price/E
(A) oil adjustment valve assembly	<b>851661</b>	<b>\$44.95</b>	(D) fill plug O-ring	<b>700013-214</b>	<b>\$1.50</b>
(B) valve gasket	<b>452531</b>	<b>2.35</b>	(E) sight disk	<b>452532</b>	<b>2.45</b>
(C) fill plug	<b>452525</b>	<b>13.10</b>	(F) sight disk seal	<b>700013-016</b>	<b>1.65</b>
			(G) sight disk lock nut	<b>452533</b>	<b>6.75</b>

## In-Line Air Filters

Designed specifically for the protection of small air tools, such as impact wrenches, nut runners, grinders and screwdrivers. The all-anodized, lightweight aluminum housing is compact can be used directly before the air tool.

- maximum operating pressure: **500 PSI**
- operating temperatures: **35°F to 200°F**
- air flow is 140 SCFM
- standard element is 40 micron, which ensures minimum pressure drop
- elements can be replaced quickly



Male NPT	Overall Length	Diameter	Weight Lbs.	Aluminum	
				Part #	Price/E
3/4"	3-13/16"	1-1/2"	.46	<b>9076M</b>	<b>\$65.00</b>

## In-Line Lubricator with Filter

Combination unit consists of **9076M** particle filter with 40 micron sintered bronze element and **PL400** (3.7 ounce) or **PL400L** (11.0 ounce) lubricator.



NPT Sizes	Oil Capacity	Maximum Work. Press.	Part #	Price/E
3/4"	3.7 fluid ozs.	<b>200 PSI</b>	<b>PL400WF</b>	<b>\$191.40</b>
3/4"	11.0 fluid ozs.	<b>300 PSI</b>	<b>PL400LWF</b>	<b>216.75</b>

## Compressor Y

- converts a single supply source to a dual outlet



Female NPT Inlet (1)	Male NPT Outlet (2)	Iron	
		Part #	Price/E
1"	3/4"	<b>Y10075</b>	<b>\$58.00</b>

## Wilkerson Miniature Lubricators



transparent bowl

- 1 oz. bowl
- adjustable oil feed
- full view sight dome

**SAFETY  
ALERT**

- Do not fill under pressure. Air supply must be turned off and pressure bled from unit prior to adding oil.

Size	SCFM	Transparent Bowl		Metal Bowl	
		Part #	Price/E	Part #	Price/E
1/8"	7.4	<b>L03-01A</b>	<b>\$70.90</b>	<b>L03-01AMB</b>	<b>\$78.35</b>
1/4"	47.5	<b>L03-02A</b>	<b>70.90</b>	<b>L03-02AMB</b>	<b>78.35</b>

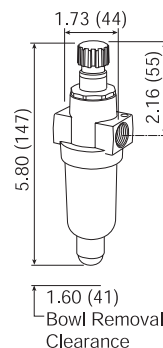

Air



metal bowl

- .6 oz. bowl
- adjustable oil feed
- full view sight dome
- fill under pressure design

Size	SCFM	Transparent Bowl		Metal Bowl	
		Part #	Price/E	Part #	Price/E
1/8"	23.5	<b>L08-01A</b>	<b>\$72.25</b>	<b>L08-01AMB</b>	<b>\$79.90</b>
1/4"	57.5	<b>L08-02A</b>	<b>72.25</b>	<b>L08-02AMB</b>	<b>79.90</b>

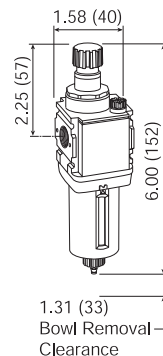

See pages 195-197 for lubricator accessories.

## Wilkerson Miniature Combination Units (Filter, Regulator, Lubricator)

- models supplied with GC620 gauge

### Miniature Transparent Bowl with Guard

Size	SCFM	Automatic Drain		Manual Drain	
		Part #	Price/E	Part #	Price/E
1/8"	4.5	<b>C03-01A</b>	<b>\$221.80</b>	<b>C03-01M</b>	<b>\$212.30</b>
1/4"	26	<b>C03-02A</b>	<b>222.60</b>	<b>C03-02M</b>	<b>213.10</b>

### Miniature Metal Bowl

Size	SCFM	Automatic Drain		Manual Drain	
		Part #	Price/E	Part #	Price/E
1/8"	4.5	<b>C03-01AMB</b>	<b>\$236.75</b>	<b>C03-01MMB</b>	<b>\$227.20</b>
1/4"	26	<b>C03-02AMB</b>	<b>237.55</b>	<b>C03-02MMB</b>	<b>228.00</b>

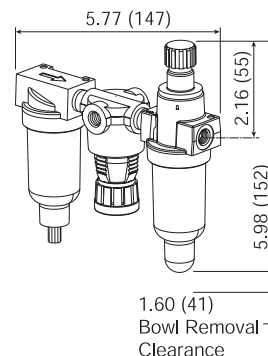

- models supplied with 0-160 PSI flush mount style gauge

### Miniature Transparent Bowl with Guard

Size	SCFM	Automatic Drain		Manual Drain	
		Part #	Price/E	Part #	Price/E
1/8"	28.7	<b>C08-01A</b>	<b>\$261.45</b>	<b>C08-01M</b>	<b>\$253.95</b>
1/4"	40	<b>C08-02A</b>	<b>261.45</b>	<b>C08-02M</b>	<b>253.95</b>

### Miniature Metal Bowl

Size	SCFM	Automatic Drain		Manual Drain	
		Part #	Price/E	Part #	Price/E
1/8"	28.7	<b>C08-01AMB</b>	<b>\$276.75</b>	<b>C08-01MMB</b>	<b>\$269.25</b>
1/4"	40	<b>C08-02AMB</b>	<b>276.75</b>	<b>C08-02MMB</b>	<b>269.25</b>

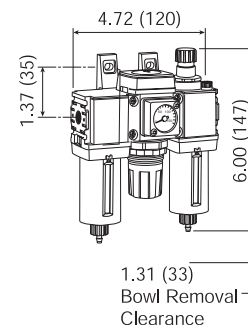

**SAFETY  
ALERT**

FRL's are designed for air service only, unless otherwise indicated.

SCFM ratings at 150 PSIG inlet pressure.

## Wilkerson Filter / Regulators

- high flow capacity
- **0-125 PSIG** range
- 5 micron filter
- 6 oz. bowl
- balanced valve design
- spring-loaded diaphragm
- maximum operating conditions:  
transparent bowl: **150 PSIG** (10 bar) and **125°F** (52°C)  
metal bowl: **250 PSIG** (17 bar) and **175°F** (79°C)

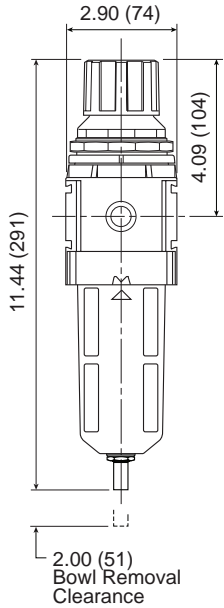

### Standard Transparent Bowl with Guard

Size	SCFM	Automatic Drain		Manual Drain	
		Part #	Price/E	Part #	Price/E
3/8"	140	<b>B28-03AG</b>	<b>\$260.70</b>	<b>B28-03MG</b>	<b>\$208.05</b>
1/2"	150	<b>B28-04AG</b>	<b>260.70</b>	<b>B28-04MG</b>	<b>208.05</b>
3/4"	165	<b>B28-06AG</b>	<b>260.70</b>	<b>B28-06MG</b>	<b>208.05</b>

### Standard Metal Bowl with Sight Glass

Size	SCFM	Automatic Drain		Manual Drain	
		Part #	Price/E	Part #	Price/E
3/8"	140	<b>B28-03AGMB</b>	<b>\$273.30</b>	<b>B28-03MGMB</b>	<b>\$223.00</b>
1/2"	150	<b>B28-04AGMB</b>	<b>273.30</b>	<b>B28-04MGMB</b>	<b>223.00</b>
3/4"	165	<b>B28-06AGMB</b>	<b>273.30</b>	<b>B28-06MGMB</b>	<b>223.00</b>



with metal bowl

See pages 197-198 for filter/regulator accessories.

## Wilkerson EconOmist® Type Lubricators

Designed so that all the oil flow observed in the sight dome is broken into a mist and delivered via the airflow to the application. This lubricator allows the user to fill or replenish the oil in the bowl without interrupting airflow or bleeding pressure from the system (except miniature models). Once the oil-fill cap is removed, the bowl is depressurized and isolated from line pressure, and the bowl itself can then be removed, if desired, for faster refill. The bowl can also be filled right to the top.

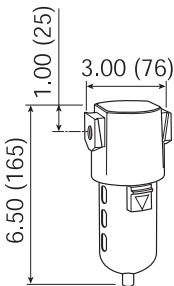

- full view sight dome
- fill under pressure design

Size	SCFM	Transparent Bowl		Metal Bowl	
		Part #	Price/E	Part #	Price/E
1/4"	28	<b>L16-02A</b>	<b>\$128.05</b>	<b>L16-02AMB</b>	<b>\$144.95</b>
3/8"	48	<b>L16-03A</b>	<b>128.05</b>	<b>L16-03AMB</b>	<b>144.95</b>
1/2"	52	<b>L16-04A</b>	<b>128.05</b>	<b>L16-04AMB</b>	<b>144.95</b>



with metal bowl

See pages 195-197 for lubricator accessories.

FRL's are designed for air service only, unless otherwise indicated.

**SAFETY**  
**ALERT**

SCFM ratings at 150 PSIG inlet pressure.

# Wilkerson Lubricators

## Flow Guide®

The elastomer disc-shaped device is located in the throat of all Wilkerson lubricators and automatically maintains a constant ratio of oil flow to airflow regardless of changing rates of airflow. This allows one lubricator to serve several pneumatic components operating together or intermittently.

## Type of oil to use:

For all Wilkerson lubricators, use any petroleum-base, non-detergent light weight oil (SAE 10/150SSU) which will readily break up into a mist, i.e., Mobil DTE light or comparable oil. Do not use any synthetic oil or oils containing additives or solvents. See page 124 for air tool lubricants.



Air

- high flow capacity
- 4.09 oz. bowl
- can be filled under pressure
- manual drain
- maximum operating conditions:  
transparent bowl: **150 PSIG** (10 bar) and **125°F** (52°C)  
metal bowl: **250 PSIG** (17 bar) and **175°F** (79°C)



with metal bowl

### Compact

Size	SCFM	Transparent Bowl		Metal Bowl	
		Part #	Price/E	Part #	Price/E
1/4"	88	<b>L18-02A</b>	<b>\$114.05</b>	<b>L18-02AMB</b>	<b>\$128.30</b>
3/8"	90	<b>L18-03A</b>	<b>114.05</b>	<b>L18-03AMB</b>	<b>128.30</b>
1/2"	96	<b>L18-04A</b>	<b>114.05</b>	<b>L18-04AMB</b>	<b>128.30</b>

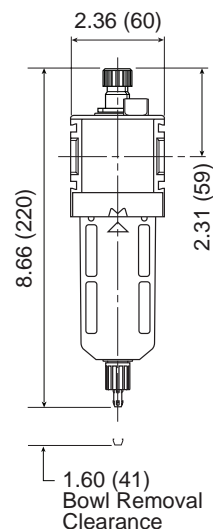

- quick-disconnect metal bowl guard with integral safety latch
- siphon tube filter provides clean lubricant downstream
- 10 oz. bowl
- can be filled under pressure
- adjustable oil feed
- maximum operating conditions:  
transparent bowl: **150 PSIG** (10 bar) and **125°F** (52°C)  
metal bowl: **200 PSIG** (14 bar) and **150°F** (65.5°C)



with metal bowl

### Standard

Size	SCFM	Transparent Bowl		Metal Bowl *	
		Part #	Price/E	Part #	Price/E
1/4"	28	<b>L26-02A</b>	<b>\$157.20</b>	<b>L26-02AMB</b>	<b>\$175.55</b>
3/8"	50	<b>L26-03A</b>	<b>157.20</b>	<b>L26-03AMB</b>	<b>175.55</b>
1/2"	102	<b>L26-04A</b>	<b>157.20</b>	<b>L26-04AMB</b>	<b>175.55</b>

\* metal bowl has sight gauge with brass petcock drain

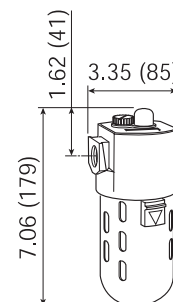

See pages 195-197 for lubricator accessories.



*FRL's are designed for air service only, unless otherwise indicated.*

SCFM ratings at 150 PSIG inlet pressure.

## Wilkerson Lubricators

- high flow capacity
- 6.11 oz. bowl
- can be filled under pressure
- manual drain
- maximum operating conditions:  
transparent bowl: **150 PSIG** (10 bar) and **125°F** (52°C)  
metal bowl: **250 PSIG** (17 bar) and **175°F** (79°C)

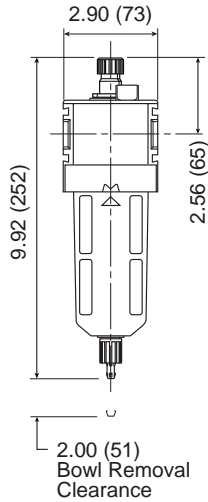

Size	SCFM	Transparent Bowl		Metal Bowl	
		Part #	Price/E	Part #	Price/E
3/8"	176	<b>L28-03A</b>	<b>\$139.65</b>	<b>L28-03AMB</b>	<b>\$154.65</b>
1/2"	184	<b>L28-04A</b>	<b>139.65</b>	<b>L28-04AMB</b>	<b>154.65</b>
3/4"	200	<b>L28-06A</b>	<b>139.65</b>	<b>L28-06AMB</b>	<b>154.65</b>



with metal bowl

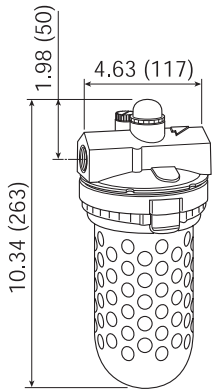

- 26 oz. bowl

Size	SCFM	Transparent Bowl		Metal Bowl	
		Part #	Price/E	Part #	Price/E
3/4"	170	<b>L30-06A</b>	<b>\$251.00</b>	<b>L30-06AMB</b>	<b>\$302.80</b>
1"	340	<b>L30-08A</b>	<b>251.00</b>	<b>L30-08AMB</b>	<b>302.80</b>



with metal bowl

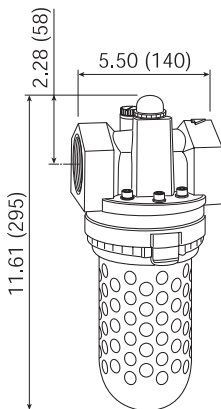

- quick-disconnect clamp ring for easy bowl removal
- manual bottom drain standard (metal bowl with sight glass only)
- 26 oz. bowl
- full view sight dome
- adjustable oil feed
- maximum operating conditions:  
transparent bowl: **150 PSIG** (10 bar) and **125°F** (52°C)  
metal bowl: **200 PSIG** (14 bar) and **150°F** (65.5°C)

Size	SCFM	Transparent Bowl		Metal Bowl	
		Part #	Price/E	Part #	Price/E
1 1/4"	850	<b>L40-0AA</b>	<b>\$568.40</b>	<b>L40-0AAMB</b>	<b>\$620.20</b>
1 1/2"	850	<b>L40-0BA</b>	<b>568.40</b>	<b>L40-0BAMB</b>	<b>620.20</b>
2"	1100	<b>L50-0CA</b>	<b>735.40</b>	<b>L50-0CAMB</b>	<b>787.20</b>



with metal bowl

illustration represents L40 series

See pages 195-197 for lubricator accessories.

*FRL's are designed for air service only, unless otherwise indicated.*

**SAFETY**  
**ALERT**

SCFM ratings at 150 PSIG inlet pressure.

## Wilkerson Lubricator Accessories

## Bowls and Bowl Guards

Used On	Description	Part #	Price/E
L00	metal bowl with manual drain	<b>GRP-96-506</b>	<b>\$48.80</b>
L03	plastic bowl with no drain	<b>PS421</b>	<b>36.90</b>
L08	metal bowl with manual drain	<b>GRP-96-714</b>	<b>43.00</b>
	plastic bowl with guard and manual drain	<b>LRP-96-736</b>	<b>30.10</b>
L16	metal bowl with sight glass and manual drain	<b>GRP-95-133</b>	<b>127.15</b>
	plastic bowl, bowl guard, manual drain	<b>GRP-95-019</b>	<b>100.05</b>
	plastic bowl with no drain	<b>LRP-96-937</b>	<b>39.90</b>
L18	metal bowl with sight glass, manual drain	<b>GRP-96-636</b>	<b>88.15</b>
	plastic bowl, bowl guard, manual drain	<b>LRP-96-701</b>	<b>70.25</b>
L26	metal bowl with sight glass and manual drain	<b>GRP-95-931</b>	<b>144.10</b>
	plastic bowl with no drain	<b>LRP-96-938</b>	<b>43.05</b>
L28	metal bowl with sight glass, manual drain	<b>GRP-96-644</b>	<b>76.10</b>
	plastic bowl, bowl guard, manual drain	<b>LRP-96-702</b>	<b>82.30</b>
L30, L40	metal bowl with sight glass and manual drain	<b>GRP-95-676</b>	<b>318.75</b>
L30, L40, L50	plastic bowl with no drain	<b>LRP-96-940</b>	<b>53.10</b>

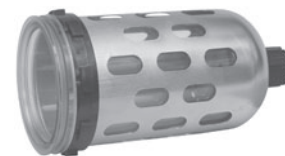

GRP-95-019

Air

## Drains

Used On	Description	Part #	Price/E
L16, L26, L40, L50	manual drain	<b>GRP-96-102</b>	<b>\$25.45</b>
L16, L26, L30, L40, L50	manual pet cock drain	<b>GRP-95-182</b>	<b>28.40</b>
L18, L28	manual drain	<b>GRP-96-685</b>	<b>16.80</b>



GRP-96-685

## Sight Domes and Fill Plugs

Used On	Description	Part #	Price/E
L00, L08, L16, L26	sight dome kit: dome and O-ring	<b>LRP-95-239</b>	<b>\$16.40</b>
L08	fill plug kit: fill plug and O-ring	<b>LRP-96-730</b>	<b>5.95</b>
L08, L18, L28	sight dome kit (old style -08)	<b>LRP-96-710</b>	<b>21.05</b>
L16, L26	sight glass kit for metal bowls	<b>GRP-95-079</b>	<b>15.30</b>
L16, L26, L30	fill plug kit: fill plug and O-ring	<b>LRP-95-253</b>	<b>10.65</b>
L18, L28	sight dome assembly (new style)	<b>LRP-96-310</b>	<b>16.10</b>
L30, L40, L50	sight dome kit: dome and O-ring	<b>LRP-95-249</b>	<b>22.10</b>
L40, L50	fill plug kit: fill plug and O-ring	<b>LRP-95-250</b>	<b>34.55</b>



LRP-95-249

## Mounting Brackets

Used On	Description	Part #	Price/E
L00	mounting bracket (L type)	<b>GRP-95-754</b>	<b>\$15.30</b>
L03	mounting bracket	<b>PS419</b>	<b>19.15</b>
L08	mounting bracket (T type) with joiner set and port O-ring	<b>GPA-96-737</b>	<b>14.00</b>
	mounting bracket (C type)	<b>GPA-97-010</b>	<b>11.85</b>
	joiner set and port O-ring	<b>GPA-96-738</b>	<b>8.50</b>
L16	mounting bracket (L type)	<b>GPA-95-016</b>	<b>33.95</b>
L18	mounting bracket (C type)	<b>GPA-96-604</b>	<b>23.95</b>
	mounting bracket (L type)	<b>GPA-96-606</b>	<b>15.70</b>
L18, L28	mounting bracket (T type)	<b>GPA-96-602</b>	<b>17.85</b>
	mounting bracket (T type) with joiner set and port O-ring	<b>GPA-96-603</b>	<b>39.05</b>
	joiner set with port O-ring	<b>GPA-96-614</b>	<b>33.05</b>
	bracket with joiner set and port O-ring	<b>GPA-96-754</b>	<b>40.50</b>
L26	mounting bracket (L type)	<b>GPA-95-946</b>	<b>41.80</b>
L28	mounting bracket (C type)	<b>GPA-96-605</b>	<b>28.20</b>
	mounting bracket (L type)	<b>GPA-96-607</b>	<b>20.80</b>
L30	wall mount, U-bolt pipe clamp	<b>GRP-95-734</b>	<b>23.55</b>



GPA-96-737

## Wilkerson Lubricator Accessories

## Modular Sleeve with Wall Mounting Brackets



GPA-95-969

- Designed for mounting a single unit or combination of units directly to the wall.
- The sleeve and mounting bracket can be ordered assembled from the factory, or just the mounting bracket alone to be used on existing modular sleeves.

Used On	Description	Part #	Price/E
L16, L26	bracket	<b>GPA-95-968</b>	<b>\$14.40</b>
	sleeve and bracket	<b>GPA-95-969</b>	<b>32.45</b>

## Modular Sleeve



GPA-95-292

- Unique modular sleeve design easily and quickly connects one or more units and accessories together without pipe nipples.
- Hand tightening the threaded pin provides a tight seal between the units.

Used On	Description	Part #	Price/E
L16, L26	modular sleeve	<b>GPA-95-292</b>	<b>\$17.00</b>

## End Blocks



GPA-97-019

- When used with the modular sleeve, end blocks allow a single unit or a combination of units to be piped into the air system in the modular mode.
- allows ease of unit servicing or replacement without disturbing the air line connections
- set of 2 blocks (inlet & outlet)

Used On	Description	Part #	Price/E
L08	end block set, 1/4" NPT	<b>GPA-97-019</b>	<b>\$35.80</b>
	end block set, 3/8" NPT	<b>GPA-97-020</b>	<b>35.80</b>

## Modular Blocks



GPA-95-919

## Manifold Block

- allows easy design flexibility
- can be installed after the filter or regulator, providing three additional 1/4" NPT tapped auxiliary ports
- inlet/outlet ports are 1/2" non-tapped
- 1-17/32" width

## End Block



GPA-95-321

- When used with the modular sleeve, end blocks allow a single unit or a combination of units to be piped into the air system in the modular mode.
- allows ease of unit servicing or replacement without disturbing the air line connections
- set of 2 blocks (inlet & outlet)

Used On	Description	Part #	Price/E
L16, L26	manifold block, three 1/4" NPT auxiliary ports	<b>GPA-95-919</b>	<b>\$51.10</b>
	end block, 1/4" NPT	<b>GPA-95-223</b>	<b>30.75</b>
	end block, 3/8" NPT	<b>GPA-95-224</b>	<b>30.75</b>
	end block, 1/2" NPT	<b>GPA-95-225</b>	<b>30.75</b>
	end block, 3/4" NPT	<b>GPA-95-320</b>	<b>62.70</b>
	end block, 1" NPT	<b>GPA-95-321</b>	<b>62.70</b>
L18, L28	end block, 1/4" NPT	<b>GPA-96-610</b>	<b>27.80</b>
	end block, 3/8" NPT	<b>GPA-96-611</b>	<b>27.80</b>
	end block, 1/2" NPT	<b>GPA-96-612</b>	<b>27.80</b>
	end block, 3/4" NPT	<b>GPA-96-613</b>	<b>27.80</b>
	end block, G1/4"	<b>GPA-96-620</b>	<b>29.90</b>
	end block, G3/8"	<b>GPA-96-621</b>	<b>29.90</b>
	end block, G1/2"	<b>GPA-96-622</b>	<b>29.90</b>
	end block, G3/4"	<b>GPA-96-623</b>	<b>29.90</b>

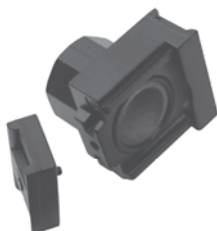

GPA-96-610

## Wilkerson Lubricator Accessories

### Modular Adapters

- When used with the modular sleeve, adapter inserts allow a single unit or a combination of units to be piped into the air system in the modular mode.
- allows ease of unit servicing or replacement without disturbing the air line connections
- set of 2 blocks

Used On	Description	Part #	Price/E
L16, L26	1/4" NPT pipe adapter	<b>GPA-95-035</b>	<b>\$43.50</b>
	3/8" NPT pipe adapter	<b>GPA-95-036</b>	<b>43.50</b>
	1/2" NPT pipe adapter	<b>GPA-95-037</b>	<b>43.50</b>



GPA-95-037

### Modular Shut-Off Valves

- can be installed immediately upstream of a single unit or combination of units
- secured to the unit with a modular sleeve or modular sleeve wall mounting bracket
- ball-type valve operates with a 1/4 turn from open to shut position
- useful for isolating and depressurizing a downstream unit requiring maintenance or replacement
- can be locked in the open position
- left to right flow

Used On	Description	Part #	Price/E
L16, L26	1/4" NPT safety lock-out valve	<b>GPA-95-096</b>	<b>\$135.85</b>
	3/8" NPT safety lock-out valve	<b>GPA-95-097</b>	<b>135.85</b>
	1/2" NPT safety lock-out valve	<b>GPA-95-098</b>	<b>135.85</b>

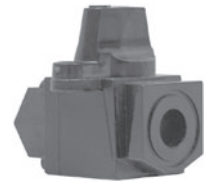

GPA-95-098

## Wilkerson Filter/Regulator Accessories

### Elements

Used On	Description	Part #	Price/E
B08	5 micron	<b>FRP-96-729</b>	<b>\$12.55</b>
CB6	5 micron	<b>FRP-95-160</b>	<b>29.30</b>
B18	5 micron	<b>FRP-96-639</b>	<b>20.15</b>
B28	5 micron	<b>FRP-96-653</b>	<b>23.95</b>



FRP-96-729

### Bowls and Bowl Guards

Used On	Description	Part #	Price/E
B08	plastic bowl with guard and manual drain	<b>GRP-96-712</b>	<b>\$25.45</b>
	metal bowl with manual drain	<b>GRP-96-714</b>	<b>43.00</b>
CB6	plastic bowl and metal bowl guard with flex tip drain	<b>FRP-95-014</b>	<b>80.95</b>
	plastic bowl and metal bowl guard with auto drain	<b>FRP-95-015</b>	<b>140.95</b>
	metal bowl with auto drain	<b>FRP-95-950</b>	<b>168.50</b>
B18	plastic bowl, bowl guard, manual drain	<b>GRP-96-634</b>	<b>70.20</b>
	plastic bowl, bowl guard, auto drain	<b>GRP-96-635</b>	<b>128.85</b>
	metal bowl with sight glass, manual drain	<b>GRP-96-636</b>	<b>88.15</b>
	metal bowl with sight glass, auto float drain	<b>GRP-96-637</b>	<b>135.45</b>
B28	plastic bowl with guard, auto drain	<b>GRP-96-643</b>	<b>163.25</b>
	plastic bowl, bowl guard, manual drain	<b>GRP-96-642</b>	<b>77.60</b>
	metal bowl, with sight glass, manual drain	<b>GRP-96-644</b>	<b>76.10</b>
	metal bowl with sight glass, auto float drain	<b>GRP-96-645</b>	<b>154.35</b>



GRP-96-636

## Series 1 Carded Miniature FRL's

Dixon offers the Series I line of miniature filters, filter/regulators, regulators and lubricators in prepackaged clear plastic units suitable for hanging on store peg racks or displays. The primary features of each unit are printed on the packaging. Each package contains 1 miniature filter, filter/regulator, regulator or lubricator and instruction sheet.



- 5 micron element
- 1 oz. reservoir
- inlet pressure **150 PSI** maximum

### Carded Miniature Filter with Transparent Bowl

Size	SCFM	Automatic Drain		Manual Drain	
		Part #	Price/E	Part #	Price/E
1/4"	21	<b>F07-200AC</b>	<b>\$56.85</b>	<b>F07-200MC</b>	<b>\$48.95</b>

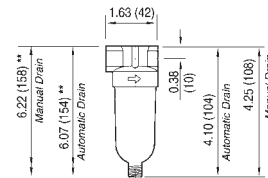

\*\* minimum clearance required to remove bowl



- **5-100 PSI** range
- relieving type
- inlet pressure **250 PSI** maximum
- model supplied with a GC620 gauge

### Carded Miniature Regulator

Size	SCFM	With Gauge	Price/E
		Part #	
1/4"	22	<b>R07-200GRC</b>	<b>\$58.50</b>

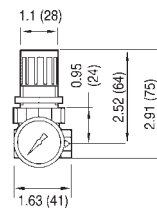

- **5-100 PSI** range
- relieving type
- 5 micron element
- 1 oz. reservoir
- push to lock adjusting knob
- inlet pressure **150 PSI** maximum
- model supplied with a GC620 gauge
- bowl guard not available

### Carded Miniature Filter/Regulator with Transparent Bowl

Size	SCFM	Automatic Drain		Manual Drain	
		Part #	Price/E	Part #	Price/E
1/4"	21	<b>B07-202AGC</b>	<b>\$116.80</b>	<b>B07-202MGC</b>	<b>\$106.35</b>

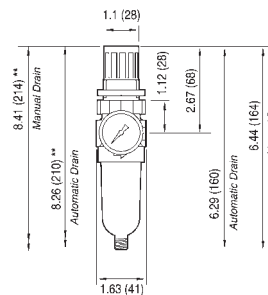

\*\* minimum clearance required to remove bowl



- 1 oz. reservoir
- inlet pressure **150 PSI** maximum

### Carded Miniature Lubricator

Size	SCFM	Transparent Bowl	Price/E
		Part #	
1/4"	14	<b>L07-200AC</b>	<b>\$73.55</b>

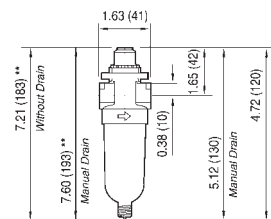

\*\* minimum clearance required to remove bowl

## Miniature Non-Repairable General Purpose Regulators



- **5-125 PSI** range
- lightweight construction
- left to right flow
- wrench flats for easy installation
- Relieving piston design allows reduction of downstream pressure when the system is dead-ended
- model supplied with a GC620 gauge

### Compact

Size	SCFM	With Gauge		Without Gauge	
		Part #	Price/E	Part #	Price/E
1/4"	13	<b>R46-200RG</b>	<b>\$52.90</b>	<b>R46-200R</b>	<b>\$37.00</b>

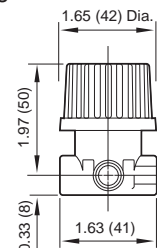

*FRL's are designed for air service only, unless otherwise indicated.*

SCFM ratings at 100 PSIG inlet pressure.

## Series 1 Micro-Fog Lubricators

- Micro-fog lubricators, identified by a red adjusting screw, are used for applications containing one or more points of lubrication, cylinders and multiple or single tools.
- Air flow through the lubricator lifts oil from the reservoir to the sight-feed dome. Oil is dropped into the fog generator and atomized into a fine mist. Lightweight particles are delivered downstream for lubrication. Heavier particles fall back into the reservoir.
- The micro-fog lubricator delivers 10% of the oil drops visible through the transparent sight-feed dome.
- *Micro-fog lubricators cannot be filled under pressure.*



- 2 oz. reservoir
- in-line or modular installation
- quick release bayonet bowl
- micro-fog design delivers aerosol mist
- recommended lubricants: misting type oil rated 50 to 200 SSU (ISO Grade 7 to 46) at **100°F**
- maximum operating conditions:  
transparent bowl: **150 PSI** and **125°F**  
metal bowl: **250 PSI** and **175°F**

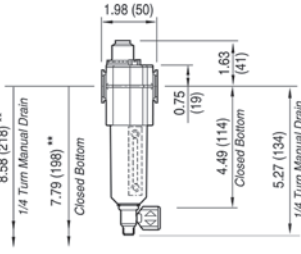

\*\* minimum clearance required to remove bowl

### 1/4"

Size	SCFM	Transparent Bowl		Metal Bowl	
		Part #	Price/E	Part #	Price/E
1/4"	51	<b>L72M-2</b>	<b>\$90.55</b>	<b>L72M-2MB</b>	<b>\$104.80</b>
3/8"	51	<b>L72M-3</b>	<b>94.00</b>	<b>L72M-3MB</b>	<b>108.10</b>



with transparent bowl

- 4 oz. reservoir
- in-line or modular installation
- quick release bayonet bowl
- micro-fog design delivers aerosol mist
- recommended lubricants: misting type oil rated 50 to 200 SSU (ISO Grade 7 to 46) at **100°F**
- maximum operating conditions:  
transparent bowl: **150 PSI** and **125°F**  
metal bowl: **250 PSI** and **175°F**

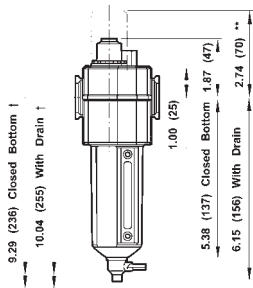

### 3/8"

Size	SCFM	Transparent Bowl		Metal Bowl	
		Part #	Price/E	Part #	Price/E
1/4"	70	<b>L73M-2</b>	<b>\$114.50</b>	<b>L73M-2MB</b>	<b>\$122.15</b>
3/8"	70	<b>L73M-3</b>	<b>114.50</b>	<b>L73M-3MB</b>	<b>122.15</b>
1/2"	70	<b>L73M-4</b>	<b>114.50</b>	<b>L73M-4MB</b>	<b>122.15</b>



with metal bowl

See pages 221-222 for lubricator accessories.

*FRL's are designed for air service only, unless otherwise indicated.*



SCFM ratings at 100 PSIG inlet pressure.

## Series 1 Micro-Fog Lubricators

- Micro-fog lubricators, identified by a red adjusting screw, are used for applications containing one or more points of lubrication, cylinders and multiple or single tools.
- Air flow through the lubricator lifts oil from the reservoir to the sight-feed dome. Oil is dropped into the fog generator and atomized into a fine mist. Lightweight particles are delivered downstream for lubrication. Heavier particles fall back into the reservoir.
- The micro-fog lubricator delivers 10% of the oil drops visible through the transparent sight-feed dome.
- *Micro-fog lubricators cannot be filled under pressure.*

**SAFETY**  
**ALERT**

Air



transparent bowl

- 7 oz. reservoir
- in-line or modular installation
- quick release bayonet bowl
- micro-fog design delivers aerosol mist
- recommended lubricants: misting type oil rated 50 to 200 SSU (ISO Grade 7 to 46) at **100°F**
- maximum operating conditions:  
transparent bowl: **150 PSI** and **125°F**  
metal bowl: **250 PSI** and **175°F**

### 1/2"

Size	SCFM	Transparent Bowl		Metal Bowl	
		Part #	Price/E	Part #	Price/E
3/8"	114	<b>L74M-3</b>	<b>\$145.10</b>	<b>L74M-3MB</b>	<b>\$148.90</b>
1/2"	154	<b>L74M-4</b>	<b>145.10</b>	<b>L74M-4MB</b>	<b>148.90</b>
3/4"	142	<b>L74M-6</b>	<b>145.10</b>	<b>L74M-6MB</b>	<b>148.90</b>

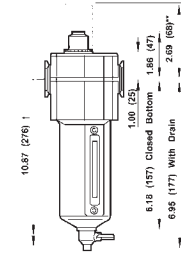

\* Optional pyrex sight-feed dome.  
1 Minimum clearance required to remove bowl.

- 1 qt. reservoir
- oil level sight gauge
- one turn threaded bowl attachment permits easy maintenance
- inlet pressure: **250 PSI**

### 1"

Size	SCFM	Metal Bowl with Sight Glass	
		Part #	Price/E
3/4"	160	<b>L17-600A</b>	<b>\$293.20</b>
1"	275	<b>L17-800A</b>	<b>293.20</b>
1 1/4"	275	<b>L17-A00A</b>	<b>343.10</b>
1 1/2"	275	<b>L17-B00A</b>	<b>343.10</b>

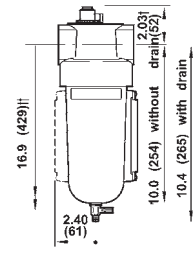

1 quart US (1 liter) reservoir  
1/4 turn drain

- 2 gallon reservoir
- oil flow can be positively set
- reservoir is ASME construction
- inlet pressure: **250 PSI**
- *cannot be filled under pressure*

**SAFETY**  
**ALERT**

### 2" General Purpose (Oil-Fog Only)

Size	SCFM	Metal Bowl with Sight Glass	
		Part #	Price/E
2"	1000	<b>10-076-004</b>	<b>\$4596.70</b>

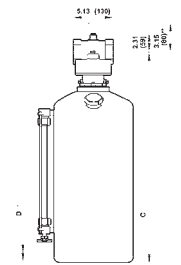

2 and 5 gallon (6 and 20 liter) reservoir  
\* Optional pyrex sight-feed dome.  
1 Minimum clearance required to remove bowl.

See pages 221-222 for lubricator accessories.

**SAFETY**  
**ALERT**

*FRL's are designed for air service only, unless otherwise indicated.*

SCFM ratings at 100 PSIG inlet pressure.

## Series 1 Lubricators - Micro-Fog, Pyrex® Sight Feed Domes

- Designed for use with alcohol or other anti-freeze agents when units are installed in cold temperature environments.
- Pyrex® sight feed dome with aluminum case and fluorocarbon O-Rings and seals; Pyrex® sight glass on bowls and metal petcock drain.
- Micro-fog lubricators, identified by a red adjusting screw, are used for applications containing one or more points of lubrication, cylinders and multiple or single tools.
- Air flow through the lubricator lifts oil from the reservoir to the sight-feed dome. Oil is dropped into the fog generator and atomized into a fine mist. Lightweight particles are delivered downstream for lubrication. Heavier particles fall back into the reservoir.
- The micro-fog lubricator delivers 10% of the oil drops visible through the transparent sight-feed dome.
- *Micro-fog lubricators cannot be filled under pressure.*

**SAFETY**  
**ALERT**

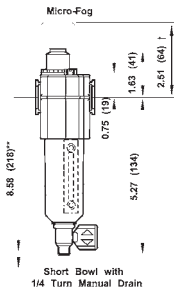

- 2 oz. reservoir
- in-line or modular installation
- quick release bayonet bowl
- micro-fog design delivers aerosol mist
- recommended lubricants: misting type oil rated 50 to 200 SSU (ISO Grade 7 to 46) at **100°F**
- inlet pressure: **250 PSI**
- maximum temperature: **175°F**

**1/4"**

Size	SCFM	Metal Bowl with Sight Glass	
		Part #	Price/E
1/4"	51	<b>L72M-2MBPX</b>	<b>\$226.05</b>
3/8"	51	<b>L72M-3MBPX</b>	<b>203.75</b>

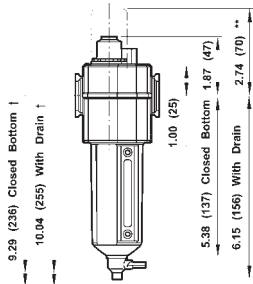

- 4 oz. reservoir
- in-line or modular installation
- quick release bayonet bowl
- micro-fog design delivers aerosol mist
- recommended lubricants: misting type oil rated 50 to 200 SSU (ISO Grade 7 to 46) at **100°F**
- inlet pressure: **250 PSI**
- maximum temperature: **175°F**

**3/8"**

Size	SCFM	Metal Bowl with Sight Glass	
		Part #	Price/E
1/4"	60	<b>L73M-2MBPX</b>	<b>\$213.60</b>
3/8"	60	<b>L73M-3MBPX</b>	<b>231.20</b>
1/2"	60	<b>L73M-4MBPX</b>	<b>231.20</b>

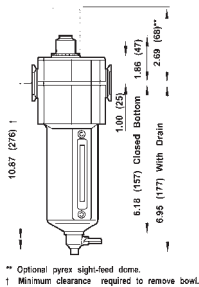

- 7 oz. reservoir
- in-line or modular installation
- quick release bayonet bowl
- micro-fog design delivers aerosol mist
- recommended lubricants: misting type oil rated 50 to 200 SSU (ISO Grade 7 to 46) at **100°F**
- inlet pressure: **250 PSI**
- maximum temperature: **175°F**

**1/2"**

Size	SCFM	Metal Bowl with Sight Glass	
		Part #	Price/E
3/8"	114	<b>L74M-3MBPX</b>	<b>\$282.45</b>
1/2"	154	<b>L74M-4MBPX</b>	<b>282.45</b>
3/4"	142	<b>L74M-6MBPX</b>	<b>282.45</b>

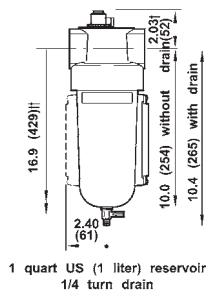

- 1 qt. reservoir
- oil level sight gauge
- particle removal per ISO 8573-1, class 5 and class 3
- one turn threaded bowl attachment permits easy maintenance
- inlet pressure: **250 PSI**

**1/2"**

Size	SCFM	Metal Bowl with Sight Glass	
		Part #	Price/E
3/4"	160	<b>L17-600APX</b>	<b>\$394.65</b>
1"	275	<b>L17-800APX</b>	<b>393.80</b>
1 1/4"	275	<b>L17-A00APX</b>	<b>419.95</b>
1 1/2"	275	<b>L17-B00APX</b>	<b>419.95</b>



See pages 221-222 for lubricator accessories.

*FRL's are designed for air service only, unless otherwise indicated.*

**SAFETY**  
**ALERT**

SCFM ratings at 100 PSIG inlet pressure.

## Series 1 Oil-Fog Lubricators

- Oil-fog lubricators, identified by a green adjusting screw, are used for lubricating a single air tool or air motor, and are located as near the device as possible.
- All the oil visible dropping through the transparent sight-feed dome goes to the airstream.
- L72C, L73C and L74C OIL-FOG lubricators can be filled under pressure.

Air



with transparent bowl

- 2 oz. reservoir
- in-line or modular installation
- quick release bayonet bowl
- micro-fog design delivers aerosol mist
- can be filled under pressure
- recommended lubricants: misting type oil rated 50 to 200 SSU (ISO Grade 7 to 46) at **100°F**
- maximum operating conditions:  
transparent bowl: **150 PSI** and **125°F**  
metal bowl: **250 PSI** and **175°F**

### 1/4"

Size	SCFM	Transparent Bowl		Metal Bowl	
		Part #	Price/E	Part #	Price/E
1/4"	51	<b>L72C-2</b>	<b>\$94.25</b>	<b>L72C-2MB</b>	<b>\$108.90</b>
3/8"	51	<b>L72C-3</b>	<b>97.60</b>	<b>L72C-3MB</b>	<b>112.40</b>

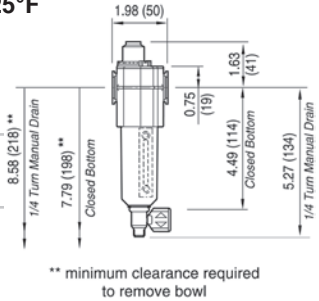

- 4 oz. reservoir
- in-line or modular installation
- quick release bayonet bowl
- micro-fog design delivers aerosol mist
- can be filled under pressure
- recommended lubricants: misting type oil rated 50 to 200 SSU (ISO Grade 7 to 46) at **100°F**
- maximum operating conditions:  
transparent bowl: **150 PSI** and **125°F**  
metal bowl: **250 PSI** and **175°F**

### 3/8"

Size	SCFM	Transparent Bowl		Metal Bowl	
		Part #	Price/E	Part #	Price/E
1/4"	60	<b>L73C-2</b>	<b>\$114.50</b>	<b>L73C-2MB</b>	<b>\$122.15</b>
3/8"	60	<b>L73C-3</b>	<b>114.50</b>	<b>L73C-3MB</b>	<b>122.15</b>
1/2"	60	<b>L73C-4</b>	<b>114.50</b>	<b>L73C-4MB</b>	<b>122.15</b>

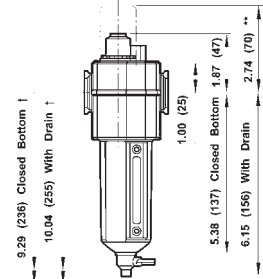

with metal bowl

See pages 221-222 for lubricator accessories.

**SAFETY**  
**ALERT**

*FRL's are designed for air service only, unless otherwise indicated.*

SCFM ratings at 100 PSIG inlet pressure.

## Series 1 Oil-Fog Lubricators

- Oil-fog lubricators, identified by a green adjusting screw, are used for lubricating a single air tool or air motor, and are located as near the device as possible.
- All the oil visible dropping through the transparent sight-feed dome goes to the airstream.
- L72C, L73C and L74C OIL-FOG lubricators can be filled under pressure.

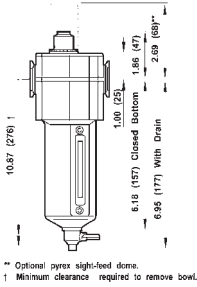

- 7 oz. reservoir
- in-line or modular installation
- quick release bayonet bowl
- micro-fog design delivers aerosol mist
- can be filled under pressure
- recommended lubricants: misting type oil rated 50 to 200 SSU (ISO Grade 7 to 46) at **100°F**
- maximum operating conditions:  
transparent bowl: **150 PSI** and **125°F**  
metal bowl: **250 PSI** and **175°F**

### 1/2"

Size	SCFM	Transparent Bowl		Metal Bowl	
		Part #	Price/E	Part #	Price/E
3/8"	118	<b>L74C-3</b>	<b>\$145.10</b>	<b>L74C-3MB</b>	<b>\$148.90</b>
1/2"	192	<b>L74C-4</b>	<b>145.10</b>	<b>L74C-4MB</b>	<b>148.90</b>
3/4"	186	<b>L74C-6</b>	<b>145.10</b>	<b>L74C-6MB</b>	<b>148.90</b>



with transparent bowl

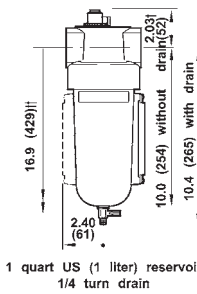

- 1 qt. reservoir
- oil level sight gauge
- *cannot be filled under pressure*
- one turn threaded bowl attachment permits easy maintenance
- inlet pressure: **250 PSI**

**SAFETY**  
**ALERT**

### 1"

Size	SCFM	Metal Bowl with Sight Glass	
		Part #	Price/E
3/4"	160	<b>L17-600D</b>	<b>\$293.20</b>
1"	275	<b>L17-800D</b>	<b>293.20</b>
1 1/4"	275	<b>L17-A00D</b>	<b>343.10</b>
1 1/2"	275	<b>L17-B00D</b>	<b>343.10</b>

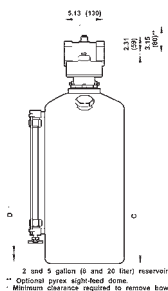

- 2 gallon reservoir
- oil flow can be positively set
- *cannot be filled under pressure*
- reservoir is ASME construction
- inlet pressure: **250 PSI**

**SAFETY**  
**ALERT**

### 2" General Purpose (Oil-Fog Only)

Size	SCFM	Metal Bowl with Sight Glass	
		Part #	Price/E
2"	1000	<b>10-076-004</b>	<b>\$4596.70</b>



See pages 221-222 for lubricator accessories.

FRL's are designed for air service only, unless otherwise indicated.

**SAFETY**  
**ALERT**

SCFM ratings at 100 PSIG inlet pressure.

## Series 1 Lubricator Accessories

## Bowls and Bowl Guards

Used On	Description	Part #	Price/E
L07	polycarbonate bowl with manual drain	<b>3646-54</b>	<b>\$16.15</b>
L08	transparent bowl with manual drain	<b>3776-54</b>	<b>62.05</b>
L72	metal bowl with Pyrex® liquid level indicator and ¼ turn manual drain	<b>4203-51RF</b>	<b>58.45</b>
L73	transparent bowl with manual drain	<b>4425-50RL</b>	<b>64.20</b>
L74	metal bowl with Pyrex® liquid level indicator and ¼ turn manual drain	<b>4303-77R</b>	<b>132.60</b>
	transparent bowl with manual drain	<b>4325-50R</b>	<b>62.55</b>
	bowl guard only	<b>4326-01</b>	<b>25.85</b>



3776-54

## Auto and Manual Drain

Used On	Description	Part #	Price/E
L08, L17	manual drain assembly	<b>2796-52</b>	<b>\$13.40</b>



2796-52

## Seal Wire

- provides tamper resistant protection of the lubricator drip rate setting

Used On	Description	Part #	Price/E
L73, L74	metal	<b>2117-01</b>	<b>\$12.50</b>



seal wire

## Domes, Caps and Plugs

Used On	Description	Part #	Price/E
L08	quick fill cap	<b>18-011-024</b>	<b>\$27.10</b>
L17, L74	quick fill cap	<b>18-011-021</b>	<b>34.00</b>
L72	acetal fill plug	<b>4272-99</b>	<b>7.00</b>
L73, L74	aluminum fill plug	<b>5301-55</b>	<b>8.65</b>
L72, L74, L73	sight feed dome (micro-fogging design)	<b>4055-50</b>	<b>24.60</b>
	sight feed dome (oil-fogging design)	<b>4055-51</b>	<b>27.35</b>
L72, L74	Pyrex® sight feed dome	<b>5605-50</b>	<b>224.40</b>
L74	liquid level indicator repair kit	<b>4380-050</b>	<b>29.60</b>



18-011-021



5605-50

## Seal Kits

Used On	Description	Part #	Price/E
L17	o-rings, seals, and gaskets	<b>5771-02</b>	<b>\$13.40</b>
L72	o-rings, seals, and gaskets	<b>4382-500</b>	<b>12.50</b>
	Viton® seal	<b>2325-10</b>	<b>8.45</b>
	buna seal	<b>720-01</b>	<b>12.50</b>
L73	o-rings, seals, and gaskets	<b>4382-600</b>	<b>8.40</b>
L74	o-rings, seals, and gaskets	<b>4382-700</b>	<b>11.15</b>
	Viton® seal	<b>2325-13</b>	<b>9.50</b>



5771-02

## Mounting Brackets

Used On	Description	Part #	Price/E
L07	mounting bracket only	<b>5095-17</b>	<b>\$12.15</b>
L08	mounting bracket only	<b>3783-52</b>	<b>43.45</b>
L17	mounting bracket kit for ¾" and 1" ported units	<b>6212-50</b>	<b>107.65</b>
	mounting bracket kit for 1¼" and 1½" ported units	<b>6212-51</b>	<b>117.75</b>

mounting bracket  
6212-50

## Series 1 Lubricator Accessories

### Wall Mounting Brackets



4324-50

- For use instead of quick-clamps and pipe adapters to secure to a wall, machine panel or other flat surface
- Use close nipples to connect combination unit and then place in bracket.

Used On	Description	Part #	Price/E
L72	wall mounting bracket for all L72 series	<b>4224-50</b>	<b>\$16.40</b>
L73	wall mounting bracket for all L73 series	<b>4424-50</b>	<b>17.75</b>
L74	wall mounting bracket for L74 series	<b>4324-50</b>	<b>21.75</b>
	wall mounting bracket for L74 series with 1 quart reservoir	<b>4324-51</b>	<b>38.60</b>

### Quick Clamps and Brackets



quick-clamp



bracket

#### Quick-clamp

- provides modular installation capability
- flanges on the products slide into V grooves in clamp
- face-sealing O-rings provide a positive seal when clamp is closed and screw tightened

#### Bracket for quick-clamp

- provides secure mounting to a wall, machine panel or other flat surface



quick-clamp with bracket

Used On	Description	Part #	Price/E
L72	quick-clamp	<b>4214-51</b>	<b>\$14.75</b>
	quick-clamp service kit (2 O-rings)	<b>4384-570</b>	<b>1.50</b>
	wall bracket for quick-clamp (uses 3/16" screws)	<b>4213-89</b>	<b>5.15</b>
	quick-clamp and bracket assembly	<b>4214-52</b>	<b>19.75</b>
L73, L74	quick-clamp	<b>4314-51</b>	<b>18.15</b>
	quick-clamp service kit (2 O-rings)	<b>4384-770</b>	<b>6.90</b>
	wall bracket for quick-clamp (uses 7/32" screws)	<b>4313-50</b>	<b>9.75</b>
	quick-clamp and bracket assembly	<b>4314-52</b>	<b>27.60</b>

### Blocks

- installs with quick-clamps
- provides additional outlets and manifolding capability



porting block



manifold block

Used On	Description	Part #	Price/E
L72	porting block, three 1/4" PTF outlets	<b>4216-50</b>	<b>\$34.50</b>
	manifold block, three 3/8" PTF outlets	<b>4228-01</b>	<b>77.80</b>
L73, L74	porting block, three 1/4" PTF outlets	<b>4316-50</b>	<b>36.00</b>
	manifold block, three 3/4" PTF outlets	<b>4328-50</b>	<b>70.45</b>

### Adapters

- installs with quick-clamps
- provides PTF connections to system piping
- sold individually

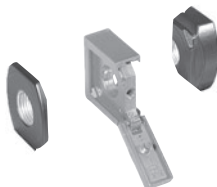

pipe adapters

Used On	Description	Part #	Price/E
L72	1/4" PTF connections	<b>4215-02</b>	<b>\$17.75</b>
	3/8" PTF connections	<b>4215-03</b>	<b>17.75</b>
L73, L74	1/4" PTF connections	<b>4315-01</b>	<b>24.10</b>
	3/8" PTF connections	<b>4315-02</b>	<b>24.10</b>
	1/2" PTF connections	<b>4315-03</b>	<b>24.10</b>
	3/4" PTF connections	<b>4315-04</b>	<b>24.10</b>

# Watts Lubricators

- general purpose
- high performance over a very wide flow range
- lubricator is fillable while under pressure
- rate of lubrication is automatically proportioned to air flow eliminating readjustment

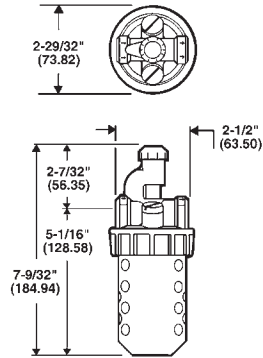

- 5 oz. bowl
- zinc body
- operating conditions:  
temperature range: **40°F** (4.4°C) to **120°F** (48.9°C)  
pressure: **150 PSIG** (10.2 bar) maximum

### Compact

Size	SCFM	Polycarbonate Bowl with Plastic Bowl Guard Part #	Price/E
1/4"	60	<b>L606-02B</b>	<b>\$137.85</b>
3/8"	90	<b>L606-03B</b>	<b>137.85</b>



Air

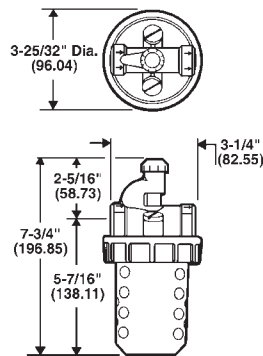

- 8 oz. bowl
- zinc body
- operating conditions:  
temperature range: **40°F** (4.4°C) to **120°F** (48.9°C)  
pressure: **150 PSIG** (10.2 bar) maximum

### Standard

Size	SCFM	Polycarbonate Bowl with Plastic Bowl Guard Part #	Price/E
1/2"	125	<b>L606-04B</b>	<b>\$164.85</b>

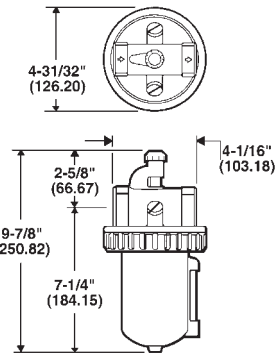

- 16 oz. bowl
- zinc body
- operating conditions:  
temperature range: **40°F** (4.4°C) to **150°F** (65.6°C)  
pressure: **250 PSIG** (17 bar) maximum

### Standard

Size	SCFM	Zinc Bowl with Sight Glass Part #	Price/E
3/4"	275	<b>L606-06W</b>	<b>\$302.30</b>
1"	320	<b>L606-08W</b>	<b>302.30</b>

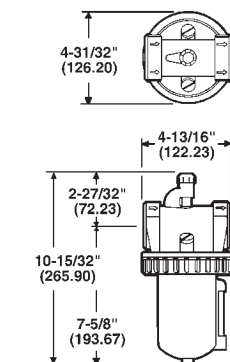

- 16 oz. bowl
- zinc body
- operating conditions:  
temperature range: **40°F** (4.4°C) to **150°F** (65.6°C)  
pressure: **250 PSIG** (17 bar) maximum

### Standard

Size	SCFM	Zinc Bowl with Sight Glass Part #	Price/E
1 1/2"	550	<b>L606-12W</b>	<b>\$363.80</b>



See page 230 for lubricator accessories.

*FRL's are designed for air service only, unless otherwise indicated.*

**SAFETY  
ALERT**

SCFM ratings at 150 PSIG inlet pressure.

## Watts Regulator Accessories

## Repair Kits



repair kit  
RK119B

Used On	Description	Part #	Price/E
R11	relieving diaphragm, valve assembly	<b>RKR10Y</b>	<b>\$38.65</b>
R119-02, R119-03	relieving diaphragm, valve assembly	<b>RK119Y</b>	<b>41.65</b>
R119-04	relieving diaphragm, valve assembly	<b>RK119A</b>	<b>51.45</b>
R119-06, R119-08	relieving diaphragm, valve assembly	<b>RK119B</b>	<b>91.90</b>
R119-12	relieving diaphragm, valve assembly	<b>RK119D</b>	<b>95.25</b>

## Accessories



mounting bracket  
SAR10Y57

Used On	Description	Part #	Price/E
R11	mounting bracket with panel nut	<b>SAR10Y57</b>	<b>\$12.60</b>
R119-02, R119-03	mounting bracket	<b>SA15Y57</b>	<b>13.70</b>
R119-04	mounting bracket	<b>18A57</b>	<b>16.50</b>
R119-06, R119-08, R119-12	mounting bracket	<b>18B57</b>	<b>40.75</b>



mounting bracket  
SA15Y57

## Watts Lubricator Accessories

## Bowls and Sight Glass Repair Kit



polycarbonate bowl  
BK602Y

Used On	Description	Part #	Price/E
L606-02, L606-03	polycarbonate bowl with plastic bowl guard	<b>BK606Y</b>	<b>\$53.85</b>
L606-04	polycarbonate bowl with plastic bowl guard	<b>BK606A</b>	<b>72.20</b>
L606-06, L606-08, L606-12	sight glass repair kit	<b>RKB605WB</b>	<b>21.20</b>

## Accessories



mounting bracket  
SA200AW57

Used On	Description	Part #	Price/E
L606-02, L606-03	mounting bracket	<b>SAF602-0571</b>	<b>\$15.95</b>
L606-04	mounting bracket	<b>SAF602-0572</b>	<b>23.85</b>
L606-06	mounting bracket (2 required)	<b>SA200AW57</b>	<b>24.25</b>
L606-08	mounting bracket (2 required)	<b>SA200CW57</b>	<b>24.25</b>