

11A 3/4" Automatic Nozzle



3/4" Automatic Nozzle

11AP Nozzle 3/4" Automatic Nozzle



3/4" Automatic Service Station Nozzle

11B Nozzle 3/4" Leaded Automatic Nozzle



3/4" Leaded Automatic Nozzle

11BP Nozzle 3/4" Unleaded Automatic Nozzle



3/4" Unleaded Automatic Nozzle

Breakaway 3/4"

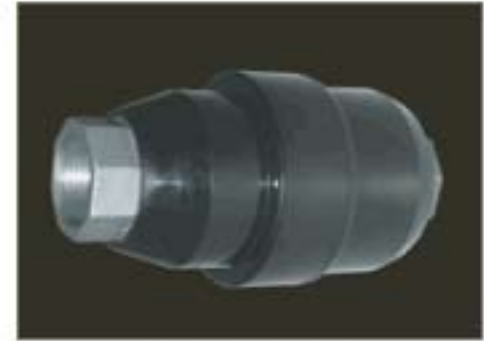

Click To Enlarge
Item #: 66-REC Breakaway
Manufacturer: OPW

The 66-REC 3/4" Breakaway is designed to be installed on fuel dispensing hoses, and will separate when subjected to a designated pull force. The dual valves seat automatically, stopping the flow of fuel and limiting any fuel spillage, while protecting the dispensing equipment. When reconnecting the separated halves, the 66-REC seals tightly on an O-ring before the poppet stems engage to open the valve.

For proper operation on high-hanging hoses, the 66-REC 3/4" must always be installed with a whip hose with a minimum length of 9". For low hose applications, the 66-REC 3/4" should be installed downstream of the retractor cable.

- Pull force - the 66-REC will break away with a pull force of no more than 250 lbs.
- Unique double-poppet design - features low pressure drop.
- Coupling halves - protected by proven plastic sleeves.
- Easily reconnected - just push and twist until you hear the audible click, signifying the unit has been correctly reconnected. Reconnection force approximately
- 15 lbs.
- Line shock - the 66-REC is able to absorb the effects of normal line shock through the unique design of the disconnecting features.
- May be reconnected under wet or dry hose conditions.
- Design Working Pressure - 50 PSI (3.45 bar) maximum pressure.

Materials:

- Body: die cast zinc
- Protective Sleeves: impact modified nylon
- Main Seals: Viton®
- Main Spring: stainless steel
- Guide and Poppets: acetal